

- LEGEND**
- EXISTING SEALED ROAD
  - EXISTING FENCE
  - PROPOSED CONCRETE PAVEMENT
  - PROPOSED ROAD WIDENING AREA
  - PROPOSED RAMP
  - PROPOSED VEGETATED AREA
  - PROPOSED GRAVEL ACCESS TRACK
  - PROPOSED STORMWATER PIPE
  - PROPOSED STORMWATER PIT
  - PROPOSED STORMWATER HEADWALL
  - PROPOSED RETAINING WALL
  - PROPOSED SAFETY BARRIER
  - TOP OF BATTER
  - BOTTOM OF BATTER
- EXISTING SURFACE CONTOURS @ 0.5m INTERVALS

- GENERAL NOTES**
1. ALL SETOUT SHALL BE BY SUITABLY EXPERIENCED PERSONNEL. ALL WORKS-AS-EXECUTED PLANS SHALL BE CERTIFIED BY A REGISTERED SURVEYOR OR ENGINEER.
  2. DIMENSIONS ARE GENERALLY IN METRES UNLESS NOTED OTHERWISE.
  3. ALL LEVELS ARE IN METRES UNLESS NOTED OTHERWISE.
  4. ALL LEVELS SHOWN ARE FINISHED SURFACE UNLESS NOTED OTHERWISE.
  5. COUNCIL INSPECTION HOLD POINTS OF CIVIL WORKS ARE REQUIRED AT THE FOLLOWING CONSTRUCTION STAGES:
    - a. PRIOR TO BACKFILLING OF STORMWATER SERVICES (PIPE TO BE TRENCHED, BEDDED AND LAID).
    - b. BOX INSPECTION OF SUBGRADE AND PROOF ROLL.
    - c. INSPECTION OF BASE GRAVELS AND PROOF ROLL PRIOR TO SEALING.
    - d. ANY SERVICE CROSSINGS OF ROAD PAVEMENT.
  6. INSPECTIONS ARE ORGANISED BY CONTACTING COUNCIL'S DEVELOPMENT ENGINEER. PLEASE NOTE 24HOURS NOTICE OF INSPECTION IS REQUIRED.
  7. DENSITY TESTING IS TO BE CARRIED OUT AT MAX. 100m SPACING OR IN ACCORDANCE WITH TABLE 8.1 OF AS 3798 - GUIDELINES ON EARTHWORKS FOR COMMERCIAL AND RESIDENTIAL DEVELOPMENT WHICHEVER GIVES THE GREATER FREQUENCY OF TESTING. COMPACTION IS TO BE TO THE FOLLOWING:
    - GENERAL FILLING TO 95% STANDARD COMPACTION.
    - SUBGRADE TO 95% STANDARD COMPACTION.
    - SUB-BASE GRAVELS TO 100% STANDARD COMPACTION.
    - BASE COURSE GRAVELS TO 100% STANDARD COMPACTION.
  8. RC PIPES OF 900 DIA OR LESS SHALL BE MINIMUM CLASS '2'. RUBBER RING JOINTED. UNLESS NOTED OTHERWISE.
  9. MINIMUM COVER TO STORMWATER PIPES SHALL BE 450mm IN LANDSCAPE AREAS. AND 600mm UNDER ROAD PAVEMENTS. UNLESS NOTED OTHERWISE.
  10. STORMWATER PITS AND DRAINAGE STRUCTURES SHALL BE TO THE LOCAL AUTHORITY STANDARDS AND CONFORM TO AS 3500. PITS OVER 1.2M DEEP SHALL HAVE GALVANISED STEP IRONS AT 300 CTS VERTICALLY AND 220 CTS HORIZONTALLY. GRATES AND FRAMES SHALL BE CAST IRON CLASS 'D' AND BICYCLE SAFE IN ACCORDANCE WITH AS 3996.
  11. THE CONTRACTOR IS RESPONSIBLE FOR MAINTAINING SUFFICIENT COVER OVER STORMWATER MAINS DURING CONSTRUCTION, AND ENSURING THAT TRENCHES ARE CORRECTLY BACKFILLED AND COMPACTED TO ELIMINATE DAMAGE CAUSED BY CONSTRUCTION TRAFFIC.
  12. GENERAL CONCRETE WORKS SHALL HAVE THE FOLLOWING PROPERTIES:
    - a. CLASS OF CONCRETE SHALL BE NORMAL.
    - b. MAXIMUM SLUMP SHALL BE 80mm.
    - c. MAXIMUM AGGREGATE SIZE SHALL BE 20mm.
    - d. MIN 28 DAYS CONCRETE COMPRESSIVE STRENGTH SHALL BE 32 MPA U.N.O.
    - e. CONCRETE WORKS SHALL CONFORM TO AS 3600.
  13. LINEMARKING AND SIGNAGE SHALL CONFORM TO AS 1742 MANUAL OF UNIFORM TRAFFIC CONTROL DEVICES.
  14. IT IS THE RESPONSIBILITY OF THE CONTRACTOR TO ENSURE THAT ADEQUATE EROSION AND SEDIMENTATION CONTROL DEVICES ARE ERECTED AND MAINTAINED AT ALL TIMES DURING CONSTRUCTION, AND TO THE SATISFACTION OF THE LOCAL AUTHORITY.
  15. ALL TRAFFIC CONTROL DURING CONSTRUCTION SHALL BE IN ACCORDANCE WITH THE RMS'S GUIDELINES - TRAFFIC CONTROL AT WORK SITES AND AS 1742.3 - 2009 MANUAL OF UNIFORM TRAFFIC CONTROL DEVICES. TRAFFIC CONTROL DEVICES FOR WORKS ON ROADS.
  16. ALL WORKS SHALL BE CARRIED OUT IN ACCORDANCE WITH THE LOCAL AUTHORITIES ENGINEERING CODE AND ASSOCIATED STANDARD DRAWINGS.
  17. IT IS THE CONTRACTOR'S RESPONSIBILITY TO PROVIDE TO THE SURVEYOR ANY INFORMATION NECESSARY TO PREPARE WORKS-AS-EXECUTED DRAWINGS FOR SUBMISSION TO THE LOCAL AUTHORITY. IT WILL BE NECESSARY TO LIAISE WITH THE SURVEYOR TO COORDINATE THE LOCATION OF SOME ITEMS PRIOR TO BACKFILLING.

This plan is NOT to be used for construction purposes unless it carries the approval stamp of the local authority.

F:\10146 C01-C07.iss E.dwg, 11/08/2021 8:57:38 AM, DWG To PDF.pc3

Issue	Date	Description	App'd
E	10/08/2021	AMENDED AS PER COUNCIL'S COMMENTS	TC
D	29/01/2021	AMENDED AS PER COUNCIL COMMENTS	TC
C	9/11/2020	AMENDED AS PER COUNCIL COMMENTS	TC
B	23/09/2020	ISSUE FOR CONSTRUCTION	TC
A	31/08/2020	DRAFT ISSUE	DW

Client  
**WARREN SHIRE COUNCIL**

Project  
**WASTE DEPOT**  
LOT 2 DP 1186656  
8161 OXLEY HIGHWAY, TENANDRA

Title  
**WARREN WASTE DEPOT**  
UPGRADE OVERVIEW

**ARDILL PAYNE**  
ENGINEERS PLANNERS SURVEYORS  
ENVIRONMENTAL PROJECT MANAGEMENT  
BALLINA 45 River Street Ph. 02 6986 3290  
GURINDAH 285 Conardly Street Ph. 02 6742 9955  
A.B.N. 51 908 558 977 e-mail: info@ardillpayne.com.au



Design	DW	Scale	1:200 @ A1 1:400 @ A3
Drawn	DW		0 2 4 6 8 10
Checked	TC	Datum	
Approved	TC	Drafting File	10146_C01-C07.dwg
Date	14/08/2020	Design File	
Job No	10146	Draw No	C01
		Issue	E

F:\10146 C01-C07 Iss E.dwg 11/08/2021 9:00:22 AM DWG To PDF.pd3

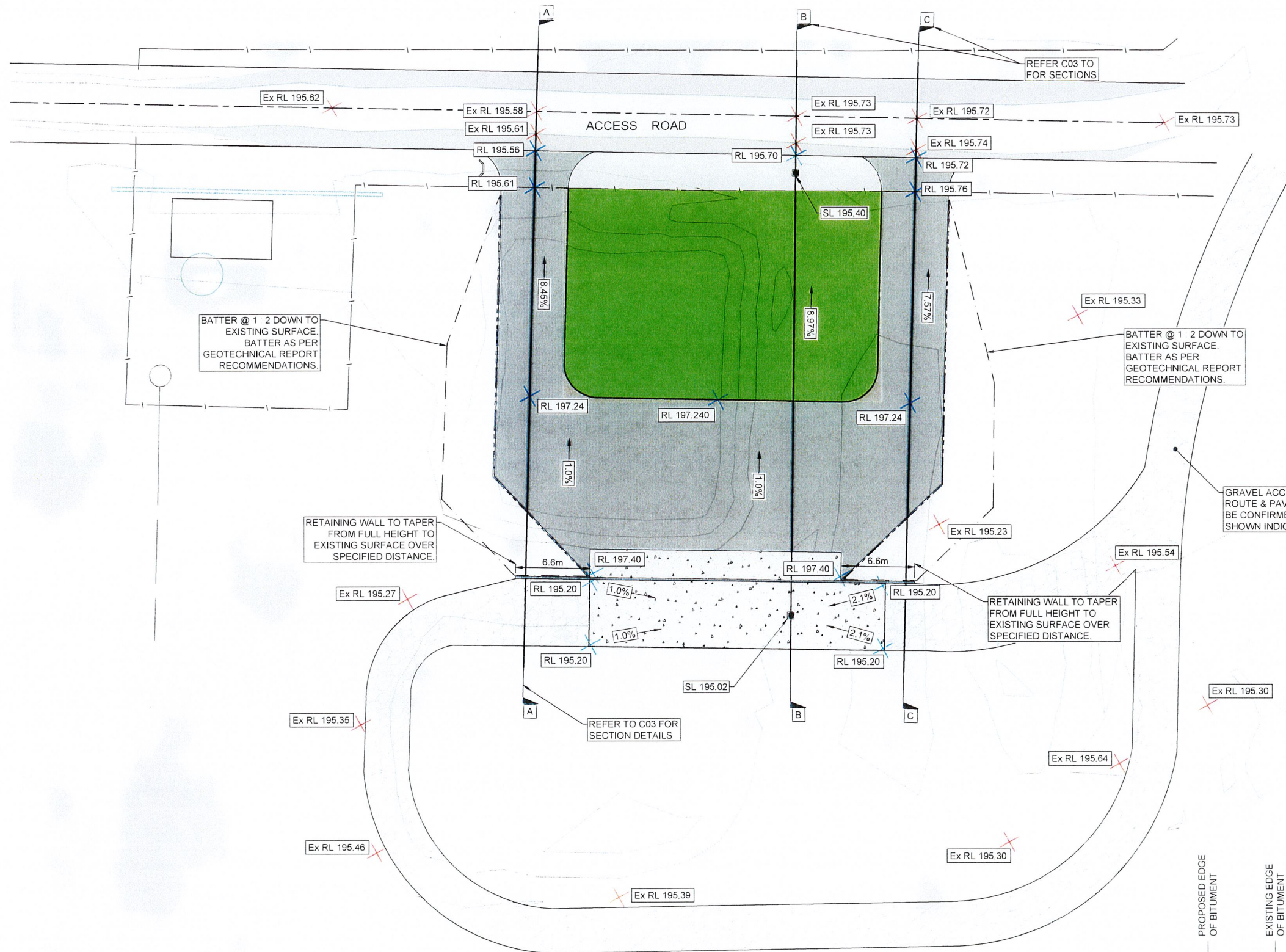

**LEGEND**

- EXISTING SEALED ROAD
- EXISTING FENCE
- PROPOSED CONCRETE PAVEMENT
- PROPOSED ROAD WIDENING AREA
- PROPOSED RAMP
- PROPOSED VEGETATED AREA
- PROPOSED GRAVEL ACCESS TRACK
- PROPOSED STORMWATER PIPE
- PROPOSED STORMWATER PIT
- PROPOSED STORMWATER HEADWALL
- PROPOSED RETAINING WALL
- EX RL 195.54 EXISTING SURFACE LEVELS
- RL 195.50 PROPOSED SURFACE LEVELS
- PROPOSED SAFETY BARRIER
- TOP OF BATTER
- BOTTOM OF BATTER
- EXISTING SURFACE CONTOURS @ 0.5m INTERVALS

**NOTE:**  
ROAD WIDENING PAVEMENT AND RAMP 0.2m PAVEMENT LIME / CEMENT STABILISED GRAVEL WITH 2 COAT BITUMEN SEAL.

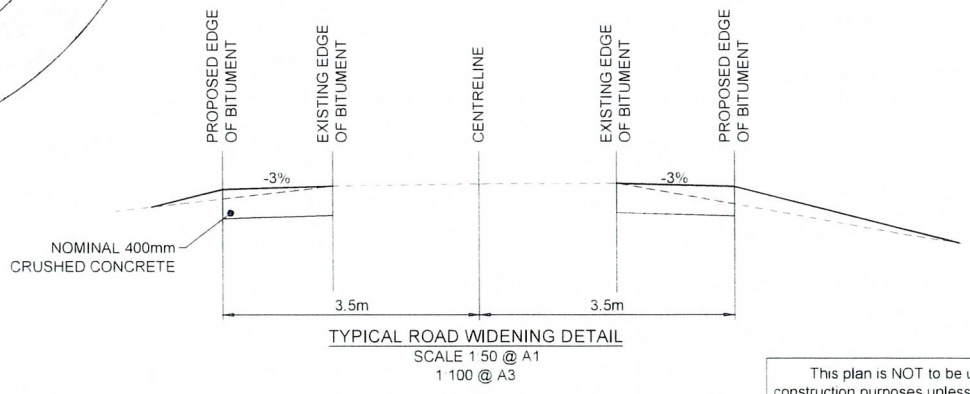
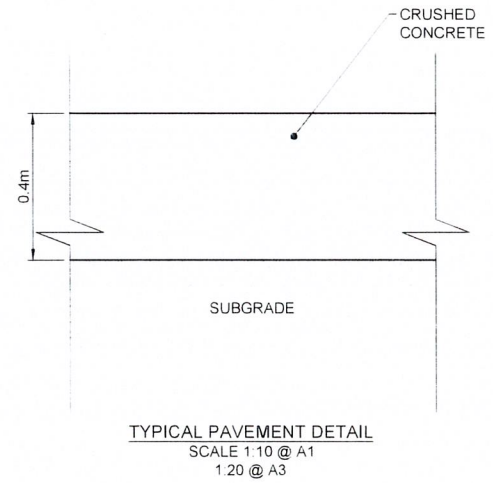

**PROPOSED SITE LEVELS OVERVIEW**  
SCALE 1:200 @ A1  
1:400 @ A3

This plan is NOT to be used for construction purposes unless it carries the approval stamp of the local authority.

Issue	Date	Description	App'd
E	10/08/2021	AMENDED AS PER COUNCIL'S COMMENTS	TC
D	29/01/2021	AMENDED AS PER COUNCIL COMMENTS	TC
C	9/11/2020	AMENDED AS PER COUNCIL COMMENTS	TC
B	23/09/2020	ISSUE FOR CONSTRUCTION	TC
A	31/08/2020	DRAFT ISSUE	DW

Client  
**WARREN SHIRE COUNCIL**

Project  
**WASTE DEPOT**  
LOT 2 DP 1186656  
8161 OXLEY HIGHWAY, TENANDRA

Title  
**PROPOSED SITE LEVELS & GRADES**

**ARDILL PAYNE**  
ENGINEERS PLANNERS SURVEYORS  
ENVIRONMENTAL PROJECT MANAGEMENT  
BALLINA 45 River Street Ph. 02 6686 3280  
GURNEEDAH 285 Conadally Street Ph. 02 6742 9955  
A.B.N. 51 808 558 977 e-mail: info@ardillpayne.com.au



Design	DW	Scale	Various - refer plan
Drawn	DW		
Checked	TC	Datum	
Approved	TC	Drafting File	10146_C01-C07_Iss E.dwg
Date	14/08/2020	Design File	
Job No	10146	Dwg No	C02
		Issue	E

F:\10146 C01-C07 Iss E.dwg 11/08/2021 9:00:49 AM DWG To PDF.pcs

**GENERAL SITE PREPARATION & FILLING SPECIFICATION**

- REMOVE EXISTING CONCRETE STRUCTURES VEGETATION AND ORGANIC SOIL FOR A MINIMUM DISTANCE OF 1.0m BEYOND THE PERIMETER OF PROPOSED BUILDINGS AND AREAS TO BE FILLED.
- WHERE SUB-GROUND STRUCTURES, TREE ROOTS ETC ARE REMOVED THEY SHALL BE REPLACED WITH NON-REACTIVE CONTROLLED FILL AND COMPACTED AS NOTED.
- BEFORE FILLING IS COMMENCED, THE STRIPPED SURFACE SHALL BE COMPACTED FOR A DEPTH OF 250mm TO A DRY DENSITY RATIO OF MORE THAN 95% STANDARD WHERE THE COMPACTION TEST IS IN ACCORDANCE WITH AS1289.
- FILLING SHALL BE CARRIED UP IN HORIZONTAL LAYERS NOT MORE THAN 200mm THICK (LOOSE MEASUREMENT) AND EACH LAYER SHALL BE COMPACTED TO SATISFY THE FOLLOWING REQUIREMENTS  
COHESIONLESS SOILS - DENSITY INDEX MORE THAN 65% WHERE COMPACTION TEST IS IN ACCORDANCE WITH AS 1289.  
COHESIVE SOILS - DRY DENSITY RATIO OF MORE THAN 95% STANDARD WHERE COMPACTION TEST IS IN ACCORDANCE WITH AS 1289.
- IMPORTED FILL SHALL BE APPROVED BY THE GEOTECHNICAL TESTING AUTHORITY AND SHALL BE FREE FROM RUBBLE, ROCKS, ORGANIC MATTER, LUMPS OF CLAY AND OTHER UNSUITABLE MATERIALS.
- THE CONTRACTOR SHALL ENGAGE AN APPROVED GEOTECHNICAL TESTING AUTHORITY FOR TESTING AND CERTIFICATION.
- REFER TO MACQUARIE GEOTECH REPORT JOB NO. B20299 FOR FURTHER DETAIL IN RELATION TO THE SITE.

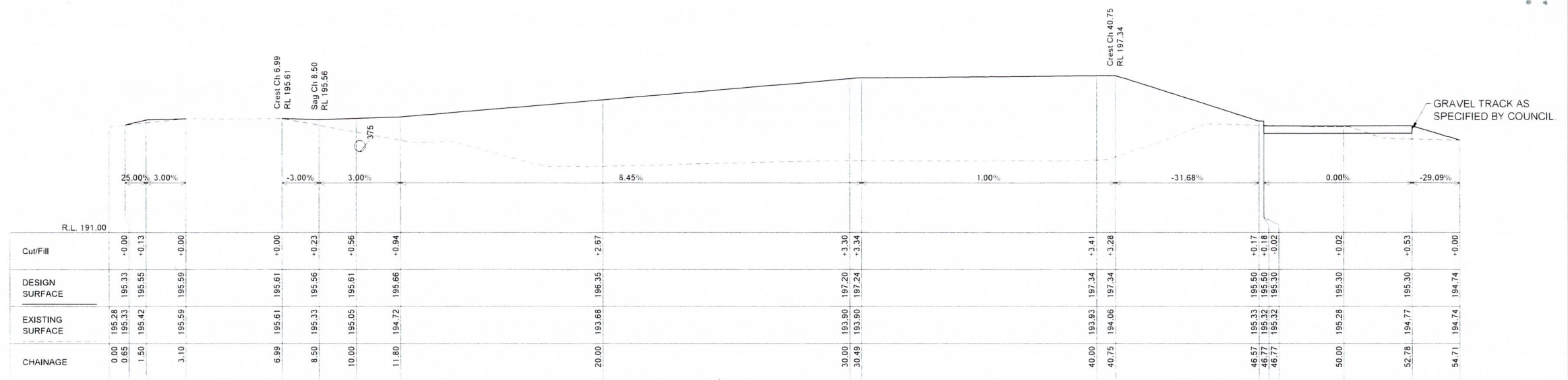

SECTION A-A  
SCALE HORIZONTAL 1 100 VERTICAL 1 100 @ A1  
HORIZONTAL 1 200 VERTICAL 1 200 @ A3

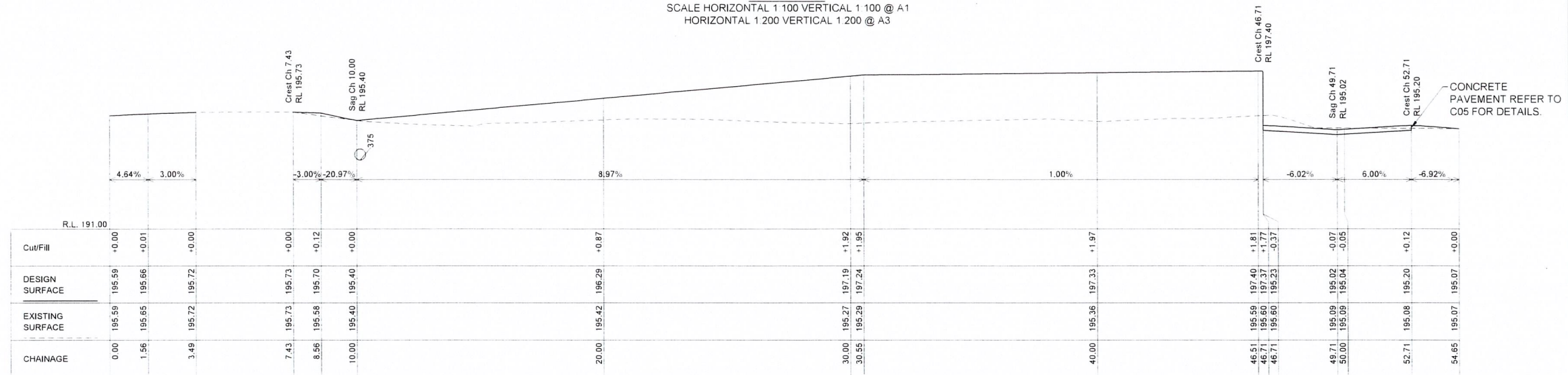

SECTION B-B  
SCALE HORIZONTAL 1 100 VERTICAL 1 100 @ A1  
HORIZONTAL 1 200 VERTICAL 1 200 @ A3

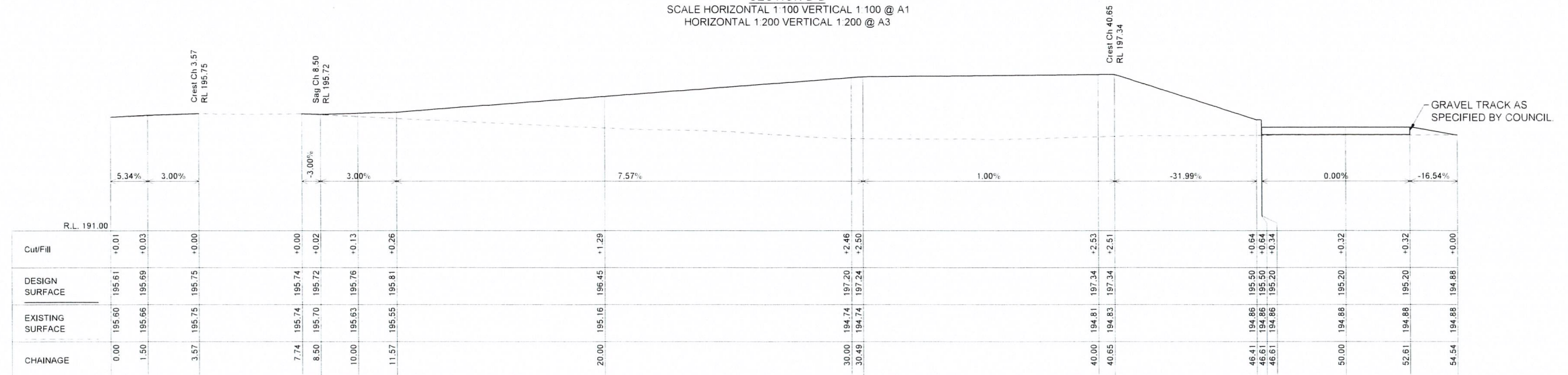

SECTION C-C  
SCALE HORIZONTAL 1 100 VERTICAL 1 100 @ A1  
HORIZONTAL 1 200 VERTICAL 1 200 @ A3

This plan is NOT to be used for construction purposes unless it carries the approval stamp of the local authority.

Issue	Date	Description	App'd
E	10/08/2021	AMENDED AS PER COUNCIL'S COMMENTS	TC
D	29/01/2021	AMENDED AS PER COUNCIL COMMENTS	TC
C	9/11/2020	AMENDED AS PER COUNCIL COMMENTS	TC
B	23/09/2020	ISSUE FOR CONSTRUCTION	TC
A	31/08/2020	DRAFT ISSUE	DW

Client  
**WARREN SHIRE COUNCIL**

Project  
**WASTE DEPOT**  
LOT 2 DP 1186656  
8161 OXLEY HIGHWAY, TENANDRA

Title  
**RAMP**  
TYPICAL SECTIONS

**ARDILL PAYNE**  
ENGINEERS PLANNERS SURVEYORS  
ENVIRONMENTAL PROJECT MANAGEMENT  
BALDWIN 45 River Street Ph: 02 9886 3280  
SURREGAR 285 Conardly Street Ph: 02 9742 9955  
A.B.N. 51 908 558 977 e-mail: info@ardillpayne.com.au



Design	DW	Scale	Various - refer plan
Drawn	DW		
Checked	TC	Datum	
Approved	TC	Drafting File	10146-C01-C07 Iss E.dwg
Date	14/08/2020	Design File	
Job No	10146	Divp No	C03
		Issue	E

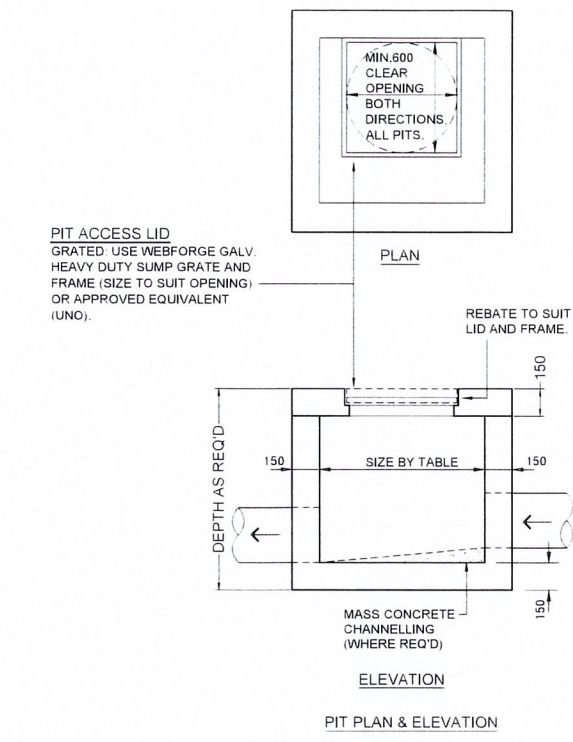
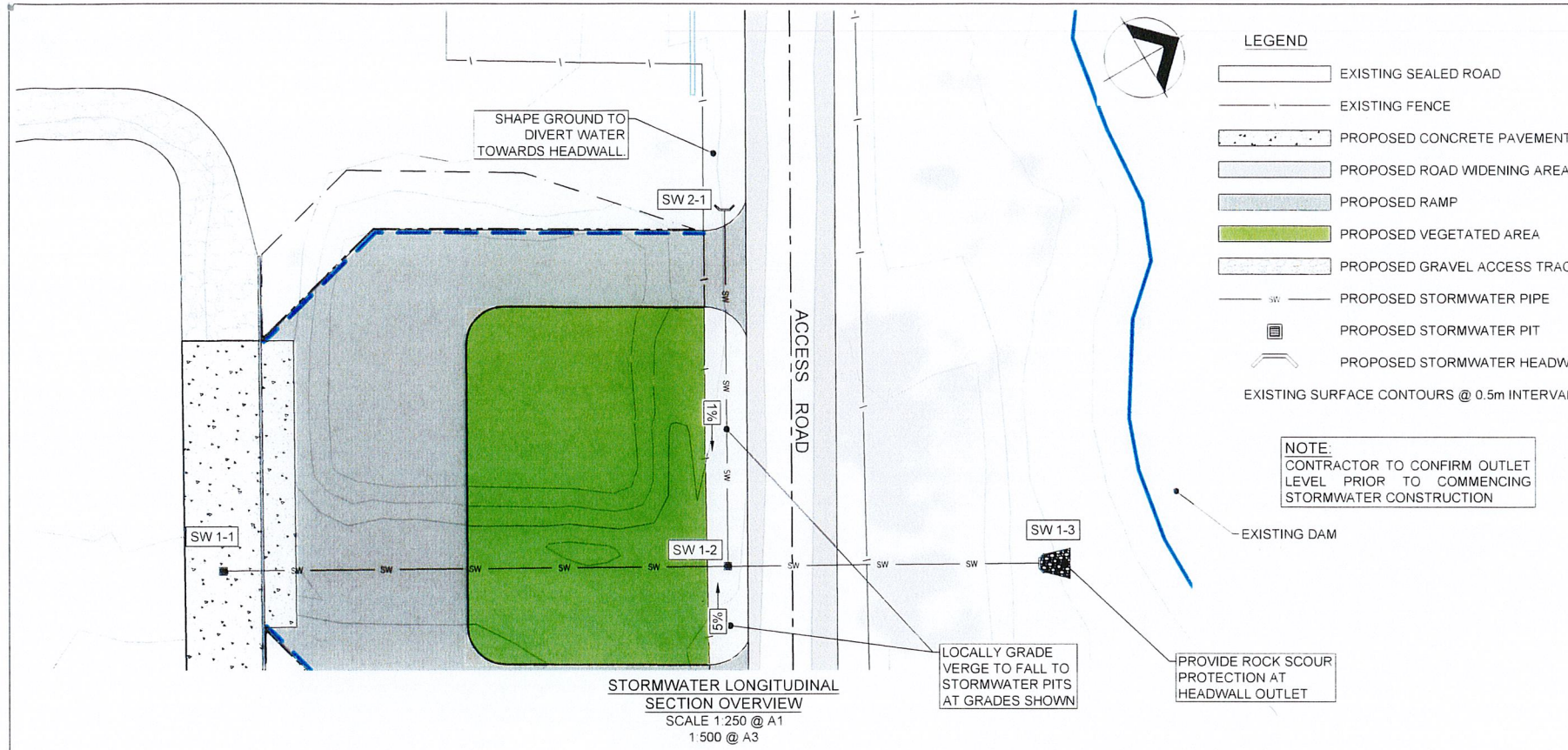

**TABLE OF MINIMUM PIT SIZES**  
REPRODUCED FROM AS/NZS 3500.3 2003 TABLE 8.2

Depth to Invert of Outlet	Minimum Internal Measurements		
	Rectangular Width	Rectangular Length	Circular Diameter
≤ 600	450	450	600
> 600 ≤ 900	600	600	900
> 900 ≤ 1200	600	900	1000
> 1200	900 (SEE NOTE 1)	900	1000

- NOTES**
- STEP IRONS SHALL BE PROVIDED IN ALL PITS OF DEPTH GREATER THAN 1200mm. IN ACCORDANCE WITH LOCAL AUTHORITY STANDARDS. APPROVED PROPRIETARY STEP IRONS COMPLYING WITH AS 1657 MAY BE USED IN LIEU OF FABRICATED STEP IRONS.
  - CONCRETE GRADE N32 TO AS 3600
  - SIDE WALLS OF PITS DEEPER THAN 1500mm SHALL BE EITHER:
    - REINFORCED WITH ONE LAYER OF SL82 PLACED CENTRALLY AND RETURNED 300mm INTO PIT BASE or
    - HAVE THICKENED WALLS AS DETAILED SEPARATELY AND/OR AS IN AS 3500

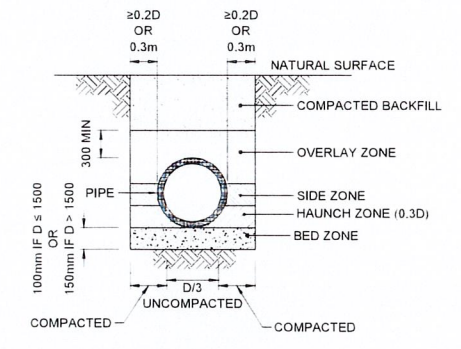

**PIPE LAYING DETAILS**  
N.T.S

AS SIEVE (mm)	PERCENTAGE PASSING BY WEIGHT	
	BED & HAUNCH ZONES	SIDE ZONES
75.0	-	100
19.0	100	-
9.50	-	50-100
2.36	50-100	30-100
0.60	20-90	15-50
0.30	10-60	-
0.15	0-25	-
0.075	0-10	0-25

- NOTE**
- THE CONTRACTOR SHALL ADVISE THE SUPERINTENDANT OF THE SOURCE OF BEDDING MATERIAL PRIOR TO IMPORTING THE MATERIAL. QUALITY DOCUMENTATION IS TO BE PROVIDED.
  - BEDDING MATERIAL FOR THE BED AND HAUNCH ZONES SHALL CONSIST OF A GRANULAR MATERIAL HAVING GRADING DETERMINED BY AS1141.11. COMPLYING WITH TABLE C221.2 AND A PLASTICITY INDEX DETERMINED BY AS1289.3 OF LESS THAN 6. SELECT FILL MATERIAL IN THE SIDE ZONES. FOR PIPE SUPPORT TYPE HS SHALL ALSO COMPLY WITH TABLE C221.1.
  - FOR MINIMUM COVER REQUIREMENTS REFER TO TABLE 7.1 AS/NZS 3500.3
  - ALL MATERIALS TO BE PLACED IN LAYERS NOT EXCEEDING 150mm COMPACTED THICKNESS & COMPACTED TO 95% STANDARD DRY DENSITY AS1289

This plan is NOT to be used for construction purposes unless it carries the approval stamp of the local authority.

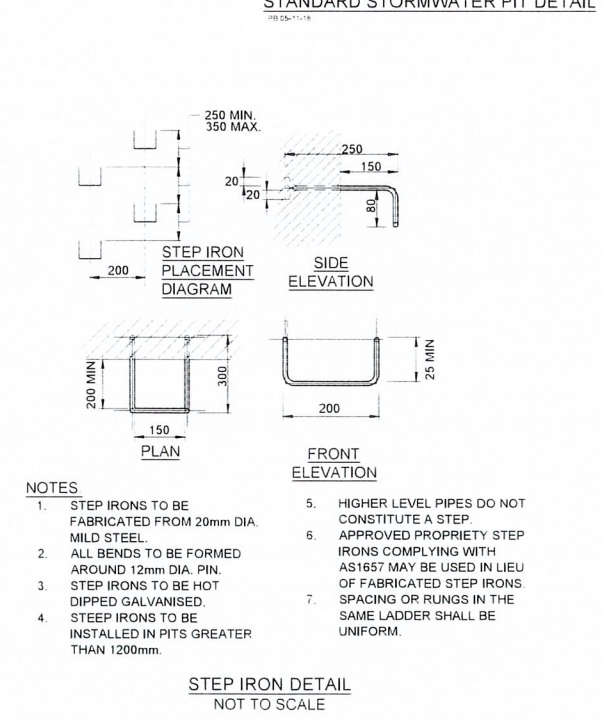
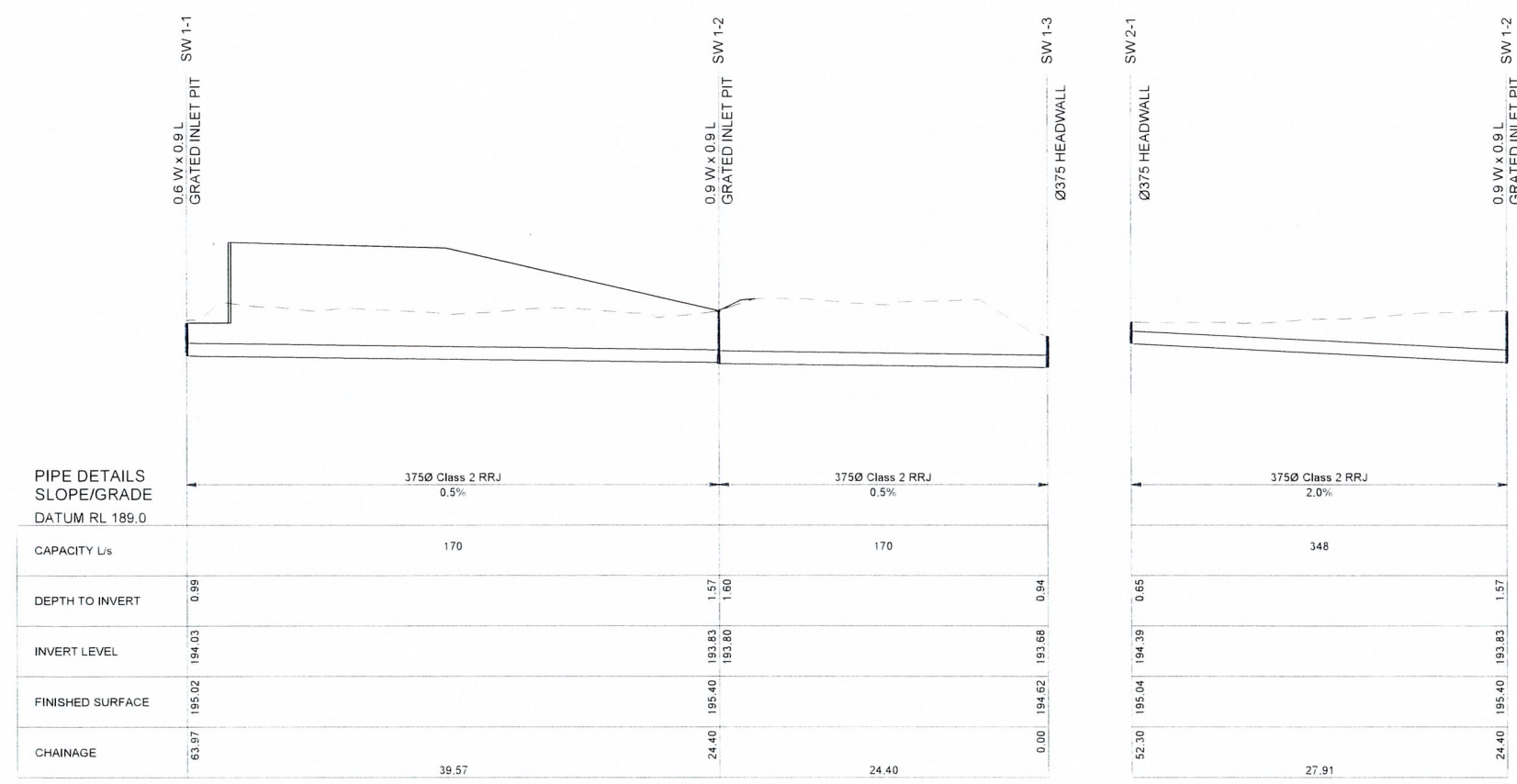

- NOTES**
- STEP IRONS TO BE FABRICATED FROM 20mm DIA. MILD STEEL.
  - ALL BENDS TO BE FORMED AROUND 12mm DIA. PIN.
  - STEP IRONS TO BE HOT DIPPED GALVANISED.
  - STEP IRONS TO BE INSTALLED IN PITS GREATER THAN 1200mm.
  - HIGHER LEVEL PIPES DO NOT CONSTITUTE A STEP.
  - APPROVED PROPRIETARY STEP IRONS COMPLYING WITH AS1657 MAY BE USED IN LIEU OF FABRICATED STEP IRONS.
  - SPACING OR RUNS IN THE SAME LADDER SHALL BE UNIFORM.

STEP IRON DETAIL  
NOT TO SCALE

STORMWATER LONGITUDINAL SECTION LINE 1  
SCALE HORIZONTAL 1 250 VERTICAL 1 100 @ A1  
HORIZONTAL 1 500 VERTICAL 1 200 @ A3

STORMWATER LONGITUDINAL SECTION LINE 2  
SCALE HORIZONTAL 1 250 VERTICAL 1 100 @ A1  
HORIZONTAL 1 500 VERTICAL 1 200 @ A3

F:\10146 C01-C07 Iss E.dwg 11/08/2021 9:01:17 AM DWG To PDF.pcc3

Issue	Date	Description	App'd
E	10/08/2021	AMENDED AS PER COUNCIL'S COMMENTS	TC
D	29/01/2021	AMENDED AS PER COUNCIL COMMENTS	TC
C	9/11/2020	AMENDED AS PER COUNCIL COMMENTS	TC
B	23/09/2020	ISSUE FOR CONSTRUCTION	TC
A	31/08/2020	DRAFT ISSUE	DW

Client  
**WARREN SHIRE COUNCIL**

Project  
**WASTE DEPOT**  
LOT 2 DP 1186656  
8161 OXLEY HIGHWAY, TENANDRA

Title  
**STORMWATER LONGITUDINAL SECTION DETAILS & NOTES**

**ARDILL PAYNE**  
ENGINEERS PLANNERS SURVEYORS  
ENVIRONMENTAL PROJECT MANAGEMENT  
BALLINA 45 River Street Ph. 02 9686 3290  
GURNEDAH 285 Conadally Street Ph. 02 9742 9955  
A.B.N. 51 808 558 977 e-mail: info@ardillpayne.com.au



Design	DW	Scale	Various - refer plan
Drawn	DW		
Checked	TC	Datum	
Approved	TC	Drafting File	10146-C01-C07 Iss E.dwg
Date	10/07/2020	Design File	
Job No	10146	Draw No	C04
		Issue	E



- LEGEND**
- — — — — EXISTING FENCE
  - ▨ PROPOSED CONCRETE PAVEMENT
  - - - - - TOP OF BATTER
  - - - - - BOTTOM OF BATTER
  - ▭ PROPOSED GRAVEL ACCESS TRACK
  - — — — — PROPOSED STORMWATER PIPE
  - PROPOSED STORMWATER PIT
  - — — — — PROPOSED RETAINING WALL
  - - - - - CONCRETE JOINTING
  - ▬▬▬ 2 x N12 TRIMMERS 1200mm LONG

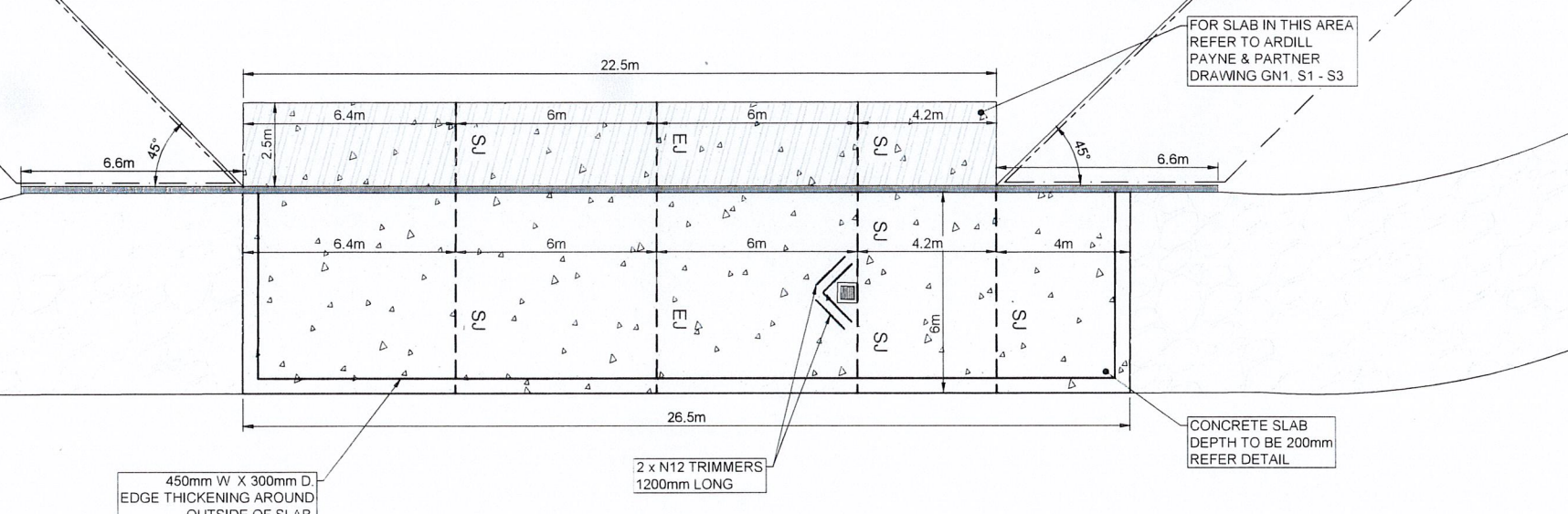

450mm W X 300mm D  
EDGE THICKENING AROUND  
OUTSIDE OF SLAB.

2 x N12 TRIMMERS  
1200mm LONG

CONCRETE SLAB  
DEPTH TO BE 200mm  
REFER DETAIL

**CONCRETE JOINTING &  
SETOUT OVERVIEW**  
SCALE 1:100 @ A1  
1:200 @ A3

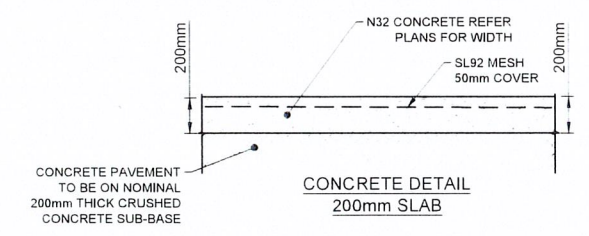
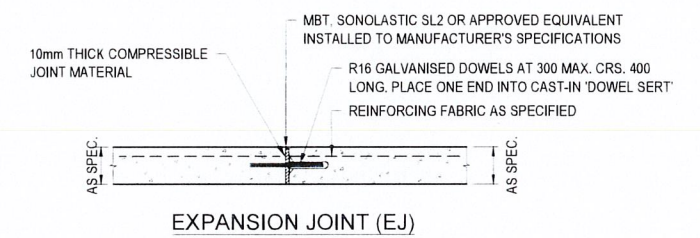
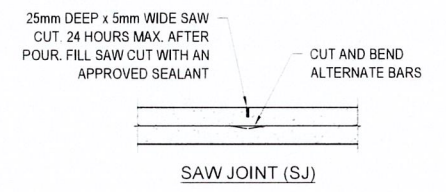

This plan is NOT to be used for construction purposes unless it carries the approval stamp of the local authority.

F:\10146 C01-C07 Iss E.dwg, 11/08/2021 9:01:42 AM, DWG To PDF, pcc3

Issue	Date	Description	App'd
E	10/08/2021	AMENDED AS PER COUNCIL'S COMMENTS	TC
D	29/01/2021	AMENDED AS PER COUNCIL COMMENTS	TC
C	9/11/2020	AMENDED AS PER COUNCIL COMMENTS	TC
B	23/09/2020	ISSUE FOR CONSTRUCTION	TC
A	31/08/2020	DRAFT ISSUE	DW

Client  
**WARREN SHIRE COUNCIL**

Project  
**WASTE DEPOT**  
LOT 2 DP 1186656  
8161 OXLEY HIGHWAY, TENANDRA

Title  
**PROPOSED CONCRETE PAVEMENT LAYOUT DETAILS & NOTES**

Do not scale drawing. Use written dimensions only.  
This plan is copyright © All rights reserved.

**ARDILL PAYNE**  
ENGINEERS PLANNERS SURVEYORS  
ENVIRONMENTAL PROJECT MANAGEMENT

BALLINA 45 River Street Ph: 02 6686 3280  
SUNNEDAH 285 Conadally Street Ph: 02 6742 9955  
A.B.N. 51 908 558 977 e-mail: info@ardillpayne.com.au



Design	DW	Scale	Various - refer plan
Drawn	DW		
Checked	TC	Datum	
Approved	TC	Drafting File	10146-C01-C07 Iss E.dwg
Date	14/08/2020	Design File	
Job No	10146	Dwg No	C05
Issue			E

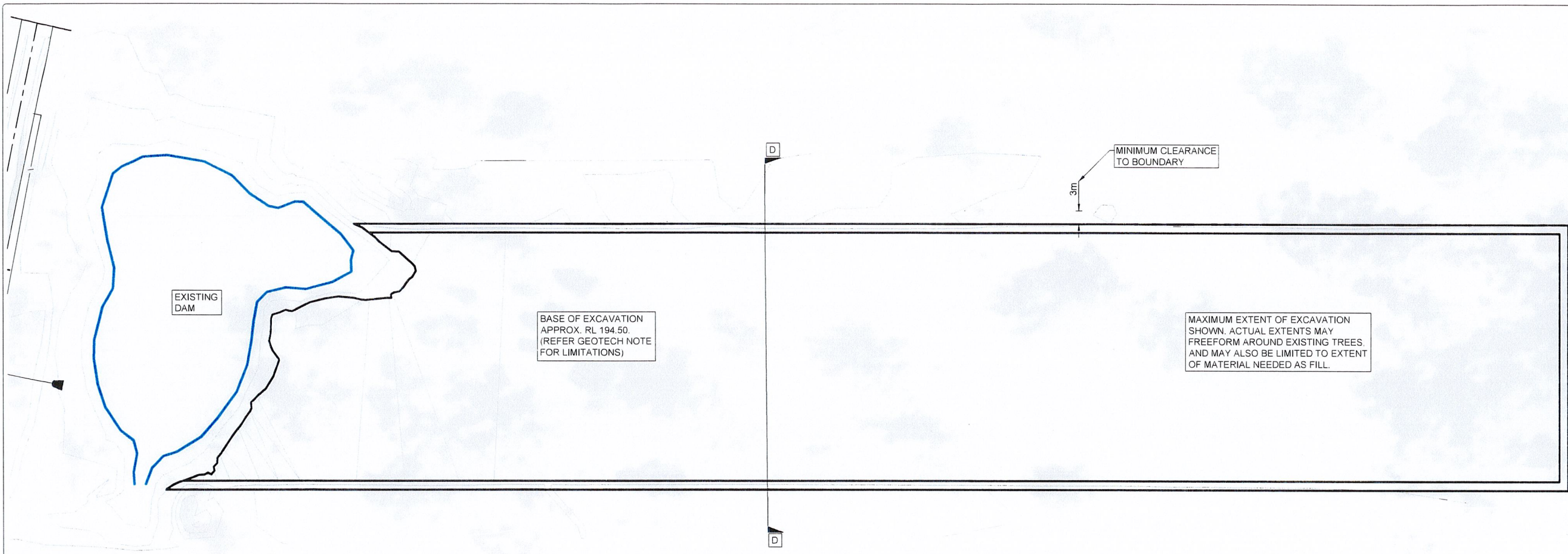

EXISTING DAM

BASE OF EXCAVATION  
APPROX. RL 194.50.  
(REFER GEOTECH NOTE  
FOR LIMITATIONS)

MAXIMUM EXTENT OF EXCAVATION  
SHOWN. ACTUAL EXTENTS MAY  
FREEFORM AROUND EXISTING TREES,  
AND MAY ALSO BE LIMITED TO EXTENT  
OF MATERIAL NEEDED AS FILL.

MINIMUM CLEARANCE  
TO BOUNDARY

3m

D

D

DAM OVERVIEW  
SCALE 1 500 @ A1  
1 1000 @ A3

GEOTECH NOTE:  
DUE TO THE HIGHLY REACTIVE NATURE OF  
ALLUVIAL SOILS IT IS NOT RECOMMENDED THAT  
ALLUVIAL SOILS BE USED AS GENERAL FILL.  
AS PER MACQUARIE GEOTECH REPORT DATED  
10/08/2020.  
SILTY CLAYEY SANDS ARE EXPECTED TO BE IN THE  
UPPER 500mm LAYER. THIS MATERIAL CAN BE USED  
IN THE WASTE DEPOT CONSTRUCTION.  
  
DO NOT EXCAVATE INTO ALLUVIAL SOILS.

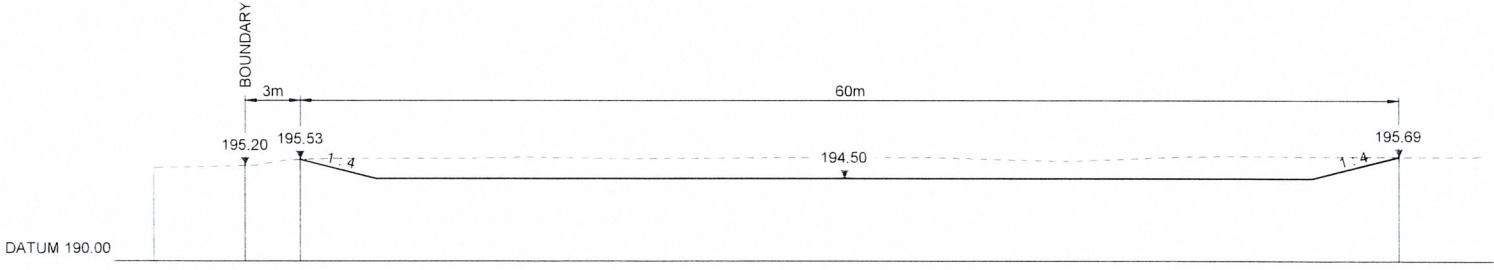

TYPICAL SECTION D-D  
SCALE 1 500 @ A1  
1 1000 @ A3

This plan is NOT to be used for  
construction purposes unless it carries the  
approval stamp of the local authority.

F:\10146 C01-C07 Iss E.dwg, 11/08/2021 9:02:07 AM, DWG To PDF.pcs

Issue	Date	Description	App'd
E	10/08/2021	AMENDED AS PER COUNCIL'S COMMENTS	TC
D	29/01/2021	AMENDED AS PER COUNCIL COMMENTS	TC
C	9/11/2020	AMENDED AS PER COUNCIL COMMENTS	TC
B	23/09/2020	ISSUE FOR CONSTRUCTION	TC
A	31/08/2020	DRAFT ISSUE	DW

Client  
**WARREN SHIRE COUNCIL**

Project  
**WASTE DEPOT**  
LOT 2 DP 1186656  
8161 OXLEY HIGHWAY, TENANDRA

Title  
**DAM EXCAVATION**  
TYPICAL SECTION & NOTES

**ARDILL PAYNE**  
ENGINEERS PLANNERS SURVEYORS  
ENVIRONMENTAL PROJECT MANAGEMENT  
BALLINA 45 River Street Ph. 02 9686 3280  
GUNNEDAH 285 Conadally Street Ph. 02 5742 9955  
A.B.N. 51 808 558 977 e-mail info@ardillpayne.com.au



Design	DW	Scale	Various - refer plan
Drawn	DW	Datum	
Checked	TC	Drafting File	10146-C01-C07 Iss E.dwg
Approved	TC	Design File	
Date	14/08/2020	Job No	10146
		Dwg No	C06
		Issue	E

Do not scale drawing. Use written dimensions only.  
This plan is copyright © All rights reserved.